



KONICA MINOLTA

**bizhub C4000i**

**bizhub C3300i**

**bizhub C3320i**

A4 Colour

# **bizhub i-SERIES**

**RETHINK  
BUSINESS**



## **C4000i**

Colour 40 PPM  
BW 40 PPM

## **C3300i**

Colour 33 PPM  
BW 33 PPM



## **C3320i**

Colour 33 PPM  
BW 33 PPM

Giving Shape to Ideas

**bizhub C4000i**  
**bizhub C3300i**

**bizhub i-SERIES**

# ACHIEVE OUTSTANDING PRODUCTIVITY

Compact A4 Laser Printer



## Outstanding productivity and operability in a compact size

### Delivers high-speed 40 ppm printing

bizhub C4000i delivers high-speed printing productivity up to 40ppm, while bizhub C3300i prints up to 33ppm, for both colour and monochrome. Warm-up time between power up and ready to print, is less than 15 seconds for colour and less than 13 seconds for monochrome. First copy out time is less than 8.7 seconds for colour and less than 8.0 seconds for monochrome, and panel rest time has been significantly reduced to 1.5 seconds.

### Duplex printing/Combine function reduces paper use

Duplex printing, and a Combine function that aggregates multiple pages onto one page (a maximum of 16 pages) come as standard. The resulting significant reduction in paper use is effective in reducing TCO (Total Cost of Ownership).

### USB direct print

Just insert a USB flash drive into the USB port, and the data can be directly printed with a few easy steps.

Compatible file formats: PDF, compact PDF, JPEG, TIFF, XPS, compact XPS, OOXML (.docx/.xlsx/.pptx), and PPML

### Equipped with 1,200 dpi High Resolution Mode

bizhub C4000i series is equipped with a 1,200 dpi High Resolution Mode\* with superb capability to reproduce small text and fine lines. It delivers high-quality output of drawings that require fine details, and documents with high-density text.

\*Print speed reduces.

### Large, easy to use 7-inch panel with new UI for better operability

The operation panel has been redesigned, now featuring familiar, smart device style operability. A large 7-inch screen delivers simpler operation with a few easy steps.

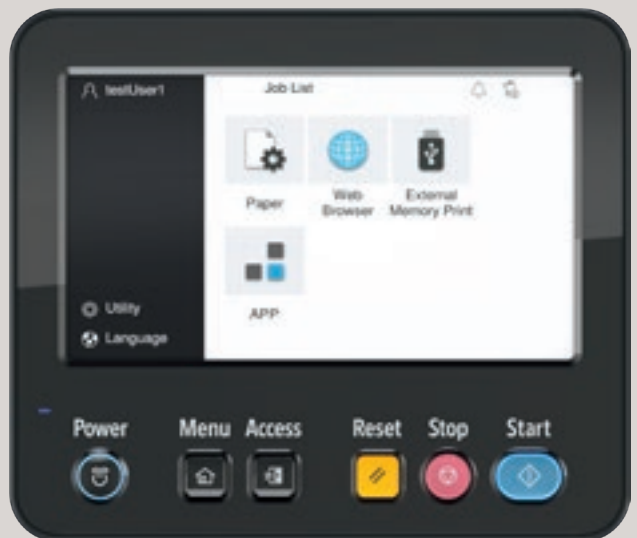

### Compatible with a wireless LAN environment\*

bizhub C4000i series can be connected to a wireless LAN in environments that lack a wired LAN. It is compatible with simple AP (Access Point) Mode which can set up a local wireless LAN environment with only the main bizhub unit. A wireless LAN can be built separately from the company LAN. Because they bypass the company LAN, even mobile devices brought in from outside can be securely connected.

\*Requires Upgrade Kit UK-221 option.

## A compact size, 420 mm wide and 528 mm deep

Achieves a small footprint enabling placement on a desktop or in tight office spaces.



## Designed for a maximum paper feed capacity of 1,600 sheets

bizhub C4000i offers an optional 500-sheet paper feed unit, where up to 2 trays can be added. Despite its compact size, it delivers substantial paper feed capacity with a maximum of 1,600 sheets, including 100 sheets from a manual feed tray.

### Standard tray: 500 sheets

Paper size: A4-A6, B5-B6  
Postcards (up to 20)  
Envelopes\* (up to 30)  
\*Creases or print defects may occur depending on the envelope type, storage and printing environment.

Max.  
**1,600**  
sheets  
(80gsm paper)



### Manual feed tray: 100 sheets

Paper size: A4-A6, B5-B6, legal  
Postcards (up to 20)  
Envelopes\* (up to 10)

\*Creases or print defects may occur depending on the envelope type, storage and printing environment.

### Paper feed unit: 500 sheets (Option)

Paper size: B5, A4, letter

\*C4000i: up to 2x paper feed units can be added.  
C3300i: 1x paper feed unit can be added.

# MOBILE & CLOUD Flexible network connectivity

## Konica Minolta Mobile Print<sup>\*1</sup> connects with mobile devices

A simple and intuitive user interface enables easy connection with mobile devices.

Documents and photos stored in the cloud can be printed.

\*1 The Android version can be downloaded from Google Play, iOS version from App Store and Windows 10 Mobile version from Microsoft Store.

\*Requires a wireless LAN environment to connect mobile devices to a network.

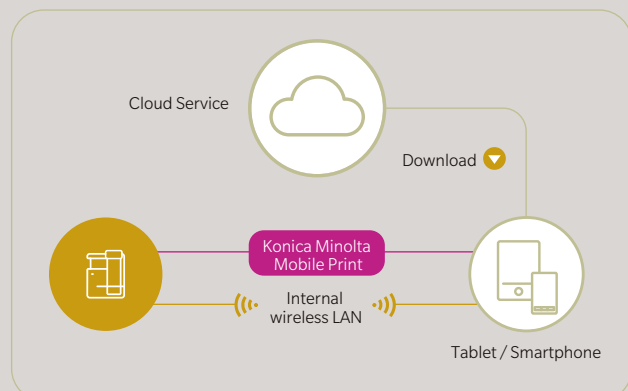

## Compatibility with mobile print services

bizhub C4000i series is compatible with a variety of services to print from smartphones and tablets.



AirPrint



Mopria  
Print Service



Konica Minolta  
Print Service

**bizhub C3320i**

**bizhub i-SERIES**

# SIMPLIFYING WORK

**Compact, easy to use  
A4 Colour Multifunctional Printer**



## A compact MFP offering ease of use and simple design

### New, easy-to-use panel design and UI for better operability

Adopting a large 7-inch touch screen, the operation panel has been redesigned and features familiar smart device style operability. Simpler operation has been achieved by narrowing down functions and screen transitions to focus on frequently-used functions. The operation panel can also be tilted to suit individual users.



### Compatible with a wireless LAN environment\*

bizhub C3320i can be connected to a wireless LAN in environments that lack a wired LAN. It is compatible with simple AP (Access Point) Mode which can set up a local wireless LAN environment with only the main bizhub unit. A wireless LAN can be built separately from the company LAN. Because they bypass the company LAN, even mobile devices brought in from outside can be securely connected.

\*Requires optional Upgrade Kit UK-221.



### A compact size, 420 mm wide and 528 mm deep

Achieves a small footprint enabling placement on a desktop or in tight office spaces.



### Designed for a maximum paper feed capacity of 1,100 sheets

bizhub C3320i offers an optional 500 sheet paper feed unit. Despite its compact body, it delivers substantial paper feed capacity with a maximum of 1,100 sheets, including 100 sheets of manual feed.

#### Standard tray: 500 sheets

Paper size: A4-A6, B5-B6  
Postcards (up to 20)  
Envelopes\* (up to 30)

\*Creases or print defects may occur depending on the envelope type, storage and printing environment.



#### Paper feed unit: 500 sheets (Option)

Paper size: B5, A4, letter

**Max.  
1,100  
sheets**  
(80gsm paper)

#### Manual feed tray: 100 sheets

Paper size: A4-A6, B5-B6, legal  
Postcards (up to 20)  
Envelopes\* (up to 10)

\*Creases or print defects may occur depending on the envelope type, storage and printing environment.

## SCAN Offers easy, handy colour scanning

### Diverse Scan Send functions

Offers a variety of sending methods including email, PC, FTP server, USB flash drive etc. This promotes smooth information sharing and a more paperless environment.

\*File formats: JPEG, PDF, compact PDF, TIFF, XPS, compact XPS, and PPTX.

### Standard Single-pass, Duplexing Automatic Document Feeder

Capable of scanning both sides of a two-sided document at once, bizhub C3320i achieves high-speed scanning, and reduces risks such as jamming of the original, because the original does not need to be reversed.

## COPY & PRINT High-speed, high-quality colour copying and printing

### High-speed 33 ppm (A4) output for colour and monochrome

In addition to a high-speed output of 33 ppm (A4), a standard duplex printing function enables highly productive and fast printing. The unit can also handle paper thicknesses up to 210 gsm.

### USB direct print

After inserting a USB flash drive into the USB port located at the side of the operation panel, printing procedures pop up on the touch screen, and the data can be printed with a few easy steps.

Compatible file formats: PDF, compact PDF, JPEG, TIFF, XPS, compact XPS, OOXML (.docx/.xlsx/.pptx), and PPML.

### Equipped with Card Shot function

When copying both sides of an irregular-sized original such as a license or business card, the front and back sides of the card can be automatically arranged to be printed on the same side of one sheet.

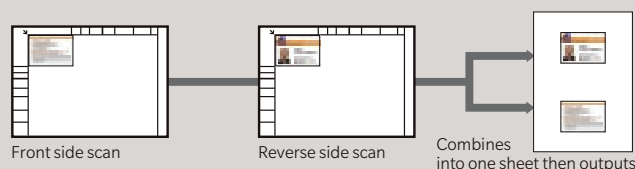

## MOBILE & CLOUD Compatible with both mobile and cloud network functions

### Konica Minolta Mobile Print<sup>\*1</sup> connects with mobile devices

A simple and intuitive user interface enables easy connection with mobile devices. Documents and photos stored in the cloud can be easily printed.

\*1 The Android version can be downloaded from Google Play, iOS version from App Store and Windows 10 Mobile version from Microsoft Store.

\* Requires a wireless LAN environment to connect mobile devices to a network.

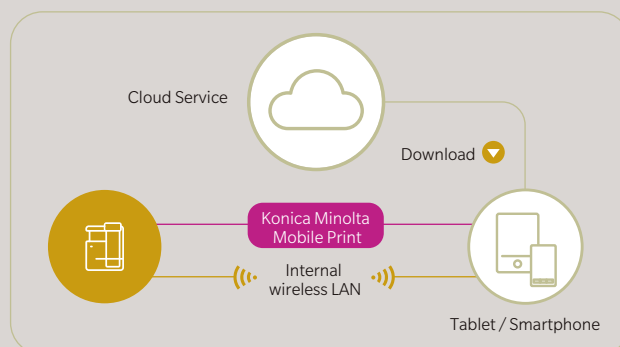

## ECOLOGY DESIGN A range of environmental considerations

### Toner Save/Skip Blank Pages functions

bizhub C3320i is equipped with a Toner Save function that enables printing with a small amount of toner, and a Skip Blank Pages function that will not print blank pages. This reduces usage of toner and paper and in turn reduces costs and environmental burden.

### Utilisation of recycled materials

Recycled materials are used in numerous places in the bizhub C3320i, achieving 60% by surface area ratio.

### Operation key enables simple power saving

Simply pressing the power key makes the switch to Sleep Mode enabling easy power saving when not in use.

### Duplex printing/Combine function reduces paper use

Duplex printing, and a Combine function that aggregates multiple pages onto one page (when copying: a maximum of 8 pages; when printing: a maximum of 16 pages) come as standard. The resulting significant reduction in paper use is effective in reducing TCO (Total Cost of Ownership).



## OPTION DESCRIPTIONS

### CONNECTIVITY

UK-221 Wireless LAN	Wireless LAN and Wireless LAN Access Point Mode
EK-P08 USB I/F kit	USB keyboard connection
EK-P09 USB I/F kit	USB keyboard connection; Bluetooth
EK-P10 NFC interface	To connect with Android mobile devices
EK-P11 I/F cable for CSRC modem	GPRS modem connection for CSRC
ID card reader	Various ID card technologies
MK-P08 Mount kit	Installation kit for ID card reader

### OTHERS

WT-P03 Working table	Authentication device placement
KP-P03 10-Key pad	For use instead of touchscreen
KH-P02 Keyboard holder	To place USB keyboard

### MEDIA INPUT

PF-P20 Paper tray	500 sheets, A4, 60-90 g/m <sup>2</sup> C4000i can support up to x2 additional PF-P20 C3300i can support x1 additional PF-P20
PF-P22 Height adjustment unit	To achieve comfortable height for operation Can be installed in place of PF-P20
DK-P04 Copier desk	Provides storage space for print media and other materials

### MEDIA OUTPUT

FS-P04 Off-line stapler	20-sheet off-line stapling includes mounting table
-------------------------	--

## TECHNICAL SPECIFICATIONS

### SYSTEM SPECIFICATIONS

Panel size/resolution	7" / 800 x 480
System memory (standard/max)	C4000i - 4GB C3000i - 3GB
System storage	8 GB (standard)
Interface	10/100/1,000-Base-T Ethernet; USB 2.0; Wi-Fi 802.11 b/g/n (optional)
Network protocols	TCP/IP (IPv4/IPv6); SMB; LPD; IPP; SNMP; HTTP(S); AppleTalk; Bonjour
Paper input capacity (standard/max)	C4000i - 600 sheets / 1,600 sheets C3300i - 600 sheets / 1,100 sheets
Paper tray input (standard)	1x 500 sheets; A6-A4; custom sizes; 60-210 g/m <sup>2</sup>
Paper tray input (optional)	1x 500 sheets; A4; 60-90 g/m <sup>2</sup> C4000i can support up to x2 optional Paper Trays C3300i can support x1 optional Paper Tray
Manual bypass	100 sheets; A6-A4; Custom sizes; 60-210 g/m <sup>2</sup>
Automatic duplexing	A5-A4; 60-210 g/m <sup>2</sup>
Finishing modes (optional)	Group; Sort; Staple (offline)
Output capacity (standard)	Max. 250 sheets
Print volume (monthly)	C4000i - Rec. 6,500 pages; Max. <sup>1</sup> 120,000 pages C3300i - Rec. 6,500 pages; Max. <sup>1</sup> 96,000 pages
Toner lifetime	Black up to 13,000 pages CMY up to 9,000 pages
Imaging unit lifetime	Black up to 200,000 pages (imaging unit) CMY up to 100,000 pages (imaging unit)
Power consumption	220-240 V / 50/60 Hz; Less than 1.45 kW
System dimension (W x D x H)	420 x 528 x 473 mm (without options)
System weight	Approx. 33.2 kg (without options)

### PRINTER SPECIFICATIONS

Imaging technology	Laser
Toner technology	Simitri® HD polymerised toner
Print resolution	1,800 (equivalent) x 600 dpi; 1200 x 1200 dpi
Print Speed A4 (mono/colour)	C4000i - Up to 40/40 ppm C3300i - Up to 33/33 ppm
1" print out time A4 (mono/colour)	C4000i - 8.0/8.7 sec. C3300i - 8.7/9.6 sec. Warm-up time Approx. 13 sec. in mono; 15 sec. in color <sup>2</sup>
Page description language	PCL 6 (XL3.0); PCL 5c; PostScript 3 (CPSI 3016); XPS
Operating System	Windows 7 (32/64); Windows 8/8.1 (32/64); Windows 10 (32/64); Windows Server 2008 (32/64); Windows Server 2008 R2; Windows Server 2012; Windows Server 2012 R2; Windows Server 2016; Windows Server 2019; Macintosh OS X 10.10 or later; Unix; Linux; Citrix
Printer fonts	80 PCL Latin; 137 PostScript 3 Emulation Latin
Mobile printing	AirPrint (iOS); Mopria (Android); Konica Minolta Mobile Print (iOS/Android/Windows 10 Mobile); Mobile Authentication and Pairing (iOS/Android) Optional: WiFi Direct

### SYSTEM FEATURES

Security Functions (standard)	IP filtering and port blocking; SSL3 and TLS1.0/1.1/1.2 network communication; IPsec support; IEEE 802.1x support; User authentication; Authentication log; Secure print; Kerberos; Print user data encryption
Accounting (standard)	Up to 100 user accounts; Active Directory support (user name + password)
Accounting Functions (optional)	ID card authentication (ID card reader); Authentication by mobile device (Android/iOS)
Software	Net Care Device Manager; Data Administrator; Web Connection; Print Status Notifier; Driver Packaging Utility; Log Management Utility

<sup>1</sup> If the maximum volume is reached within a period of one year, then a maintenance cycle must be performed

<sup>2</sup> Warm-up time may vary depending on the operating environment and usage

- All specifications refer to A4-size paper of 80 g/m<sup>2</sup> quality.
- The support and availability of the listed specifications and functionalities varies depending on operating systems, applications and network protocols as well as network and system configurations.
- The stated life expectancy of each consumable is based on specific operating conditions such as page coverage for a particular page size (5% coverage of A4). The actual life of each consumable will vary depending on use and other printing variables including page coverage, page size, media type, continuous or intermittent printing, ambient temperature and humidity.
- Some of the product illustrations contain optional accessories.
- Specifications and accessories are based on the information available at the time of printing and are subject to change without notice.
- Konica Minolta does not warrant that any specifications mentioned will be error-free.
- All brand and product names may be registered trademarks or trademarks of their respective holders and are hereby acknowledged.

## OPTION DESCRIPTIONS

### ENHANCED FEATURES

LK-116 Antivirus	Bitdefender® Antivirus provides real time scanning of all incoming and outgoing data
------------------	--

### CONNECTIVITY

FK-517 Fax board	Super G3 fax; digital fax functionality
UK-221 Wireless LAN	Wireless LAN and wireless LAN Access Point Mode
EK-P08 USB I/F kit	USB keyboard connection
EK-P09 USB I/F kit	USB keyboard connection; Bluetooth
EK-P10 NFC interface	To connect with Android mobile devices
EK-P11 I/F cable for CSRC modem	GPRS modem connection for CSRC
ID card reader	Various ID card technologies
MK-P08 Mount kit	Installation kit for ID card reader

### OTHERS

WT-P03 Working table	Authentication device placement
KP-P03 10-Key pad	For use instead of touchscreen
KH-P02 Keyboard holder	To place USB keyboard

### MEDIA INPUT

PF-P20 Paper tray	500 sheets, A4, 60-90 g/m <sup>2</sup>
PF-P22 Height adjustment unit	To achieve comfortable height for operation
DK-P04 Copier desk	Provides storage space for print media and other materials

### MEDIA OUTPUT

FS-P04 Off-line stapler	20-sheet off-line stapling
-------------------------	----------------------------

## TECHNICAL SPECIFICATIONS

### SYSTEM SPECIFICATIONS

Panel size/resolution	7" / 800 x 480
System memory (standard/max)	4 GB
System storage	16 GB (standard)
Interface	10/100/1,000-Base-T Ethernet; USB 2.0; Wi-Fi 802.11 b/g/n (optional)
Network protocols	TCP/IP (IPv4/IPv6); SMB; LPD; IPP; SNMP; HTTP(S); AppleTalk; Bonjour
Automatic document feeder (standard)	Up to 80 originals; A6-A4; 50-128 g/m <sup>2</sup> ; Dualscan ADF
Paper input capacity (standard/max)	600 sheets / 1,100 sheets
Paper tray input (standard)	1x 500 sheets; A6-A4; custom sizes; 60-210 g/m <sup>2</sup>
Paper tray input (optional)	1x 500 sheets; A4; 60-90 g/m <sup>2</sup>
Manual bypass	100 sheets; A6-A4; custom sizes; 60-210 g/m <sup>2</sup>
Automatic duplexing	A4; 60-210 g/m <sup>2</sup>
Finishing modes (optional)	Group; Sort; Staple (offline)
Output capacity (standard)	Max. 250 sheets
Copy/print volume (monthly)	Rec. 6,500 pages; Max. <sup>1</sup> 96,000 pages
Toner lifetime	Black up to 13,000 pages CMY up to 9,000 pages
Imaging unit lifetime	Black up to 200,000 pages (imaging unit) CMY up to 100,000 pages (imaging unit)
Power consumption	220-240 V / 50/60 Hz; Less than 1.45 kW
System dimension (W x D x H)	420 x 528 x 572 mm (without options)
System weight	Approx. 38.4 kg (without options)

### PRINTER SPECIFICATIONS

Print resolution	1,800 (equivalent) x 600 dpi; 1200 x 1200 dpi
Page description language	PCL 6 (XL3.0); PCL 5c; PostScript 3 (CPSI 3016); XPS
Operating System	Windows 7 (32/64); Windows 8/8.1 (32/64); Windows 10 (32/64); Windows Server 2008 (32/64); Windows Server 2008 R2; Windows Server 2012; Windows Server 2012 R2; Windows Server 2016; Windows Server 2019; Macintosh OS X 10.10 or later; Unix; Linux; Citrix
Printer fonts	80 PCL Latin; 137 PostScript 3 Emulation Latin
Mobile printing	AirPrint (iOS); Mopria (Android); Konica Minolta Mobile Print (iOS/Android/Windows 10 Mobile); Mobile Authentication and Pairing (iOS/Android) Optional: WiFi Direct

### SCANNER SPECIFICATIONS

Scan speed (mono/colour)	Up to 28/28 ipm in simplex Up to 56/56 ipm in duplex
Scan modes	Scan-to-eMail (Scan-to-Me); Scan-to-SMB (Scan-to-Home); Scan-to-FTP; Scan-to-USB; Scan-to-WebDAV; Scan-to-URL
File formats	JPEG; TIFF; PDF; Compact PDF; Encrypted PDF; XPS; Compact XPS; PPTX
Scan destinations	2,100 (single + group); LDAP support

### COPIER SPECIFICATIONS

Imaging technology	Laser
Toner technology	Simitri® HD polymerised toner
Copy/print speed A4 (mono/colour)	Up to 33/33 ppm
Autoduplex speed A4 (mono/colour)	Up to 33/33 ppm
1 <sup>st</sup> copy out time A4	6.0/7.2 sec.
Warm-up time	Approx. 13 sec. in mono; 15 sec. in colour <sup>2</sup>
Copy resolution	600 x 600 dpi
Gradation	256 gradations
Multicopy	1-9,999
Original format	A6-A4; Custom sizes
Magnification	25-400% in 0.1% steps; Auto-zooming

### FAX SPECIFICATIONS (OPTIONAL)

Fax standard	Super G3 (optional)
Fax transmission	Analogue; i-Fax; Colour i-Fax; IP-Fax
Fax resolution	Up to 600 x 600 dpi
Fax compression	MH; MR; MMR; JBIG
Fax modem	Up to 33.6 Kbps
Fax destinations	2,100 (single + group)

### SYSTEM FEATURES

Security Functions (standard)	IP filtering and port blocking; SSL3 and TLS1.0/1.1/1.2 network communication; IPsec support; IEEE 802.1x support; User authentication; Authentication log; Secure print; Kerberos
Security Functions (optional)	Antivirus realtime scanning (Bitdefender®)
Accounting (standard)	Up to 100 user accounts; Active Directory support (user name + password + e-mail + smb folder); User function access definition
Accounting Functions (optional)	ID card authentication (ID card reader); Authentication by mobile device (Android/iOS)
Software	Net Care Device Manager; Data Administrator; Web Connection; Print Status Notifier; Driver Packaging Utility; Log Management Utility

<sup>1</sup> If the maximum volume is reached within a period of one year, then a maintenance cycle must be performed

<sup>2</sup> Warm-up time may vary depending on the operating environment and usage

- All specifications refer to A4-size paper of 80 g/m<sup>2</sup> quality.
- The support and availability of the listed specifications and functionalities varies depending on operating systems, applications and network protocols as well as network and system configurations.
- The stated life expectancy of each consumable is based on specific operating conditions such as page coverage for a particular page size (5% coverage of A4). The actual life of each consumable will vary depending on use and other printing variables including page coverage, page size, media type, continuous or intermittent printing, ambient temperature and humidity.
- Some of the product illustrations contain optional accessories.
- Specifications and accessories are based on the information available at the time of printing and are subject to change without notice.
- Konica Minolta does not warrant that any specifications mentioned will be error-free.
- All brand and product names may be registered trademarks or trademarks of their respective holders and are hereby acknowledged.



KONICA MINOLTA

## NEW SOUTH WALES

Konica Minolta House  
4 Drake Avenue  
Macquarie Park NSW 2113  
(02) 8026 2222

## SOUTH AUSTRALIA

L1 84 Greenhill Road  
Wayville SA 5034  
(08) 8231 2911

## ACT

1/55 Wentworth Avenue  
Kingston ACT 2604  
(02) 6206 6500

## VICTORIA

Level 5, 441 St Kilda Road  
Melbourne VIC 3004  
(03) 8699 0777

## QUEENSLAND

Level 9, 100 Skyring Terrace  
Newstead QLD 4006  
(07) 3872 9100

## WESTERN AUSTRALIA

66 Kings Park Road  
West Perth WA 6005  
08 6380 3700

Konica Minolta  
Business Solutions Australia Pty Ltd

**Free Call 1800 789 389**  
**[konicaminolta.com.au](http://konicaminolta.com.au)**



\*bizhub C3320i only

